

PHASING DIAGRAM



PHASING DIAGRAM DETECTION LEGEND

- ←● DETECTED MOVEMENT
- ← UNDETECTED MOVEMENT (OVERLAP)
- ← UN SIGNALIZED MOVEMENT
- ← PEDESTRIAN MOVEMENT

SIGNAL FACE	PHASE		
	Ø 2+6	Ø 4+8	F
21,22	G	R	Y
41,42	R	G	R
61,62	G	R	Y
81,82,83	R	G	R

SIGNAL FACE I.D.

All Heads L.E.D.

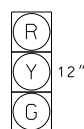

21,22
41,42
61,62
81,82,83

LOOP	SIZE (FT)	DISTANCE FROM STOPBAR (FT)	TURNS	NEW LOOP	DETECTOR PROGRAMMING							
					PHASE	CALLING	EXTENSION	FULL TIME DELAY	STRETCH TIME	DELAY TIME	SYSTEM LOOP	NEW CARD
2A	6X6	300	5	Y	2	Y	Y	-	-	-	-	Y
4A	6X40	0	2-4-2	Y	4	Y	Y	-	-	10	-	Y
6A	6X6	250	5	Y	6	Y	Y	-	-	-	-	Y
8A	6X40	0	2-4-2	Y	8	Y	Y	-	-	10	-	Y

2 Phase Fully Actuated (Isolated) NOTES

- Refer to "Roadway Standard Drawings NCDOT" dated January 2018 and "Standard Specifications for Roads and Structures" dated January 2018.
- Do not program signal for late night flashing operation unless otherwise directed by the Engineer.
- Locate new cabinet so as not to obstruct sight distance of vehicles turning right on red.
- Set all detector units to presence mode.
- See Pavement Marking & Signing Plan for proposed pavement markings.
- The cabinet should be designed to include an Auxiliary Output file for future use.
- Provide a minimum vertical clearance 17'-6" below signal heads 21,41,61 and 81 to accommodate future 4-section signal heads.

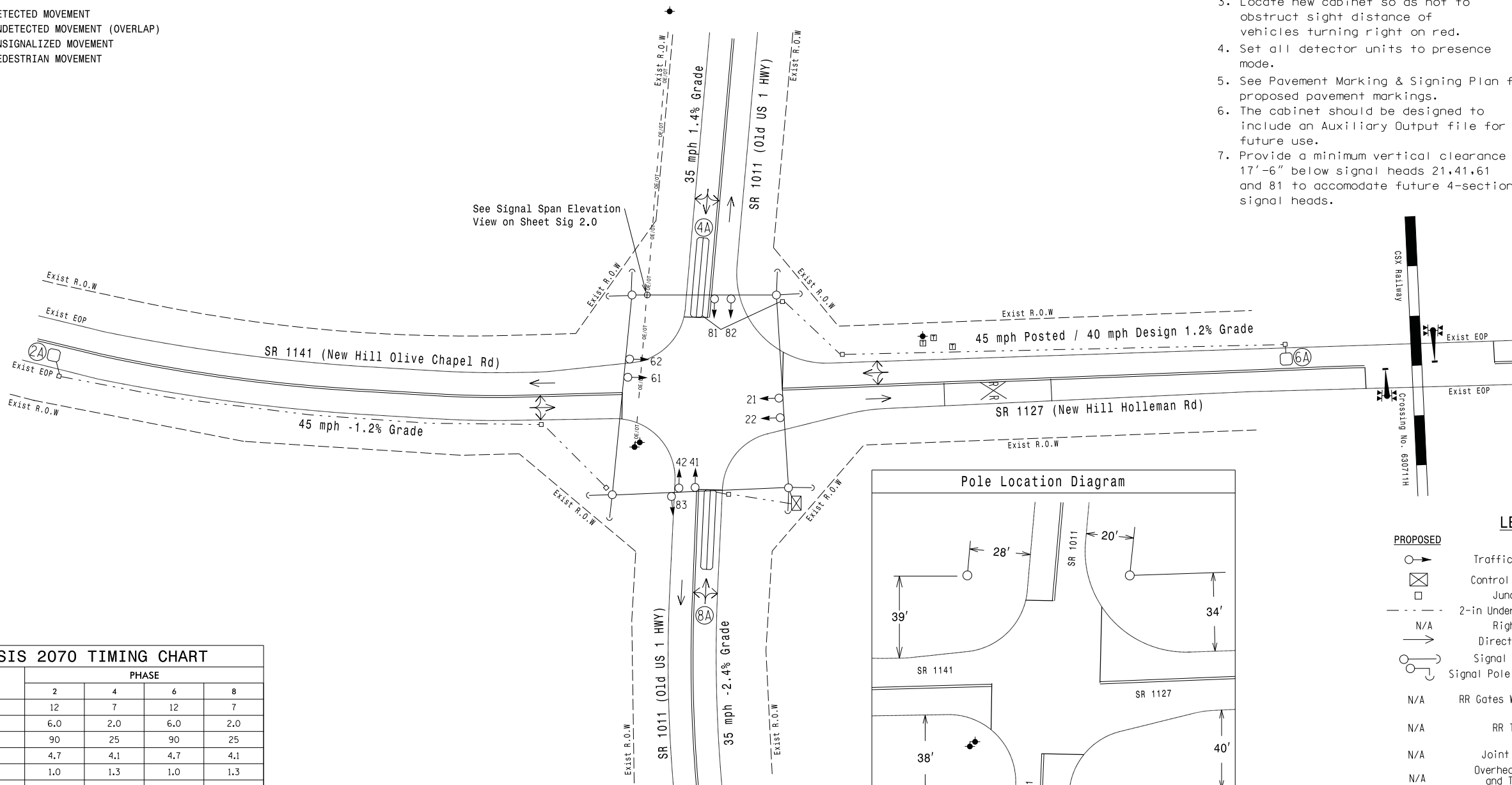

FEATURE	PHASE			
	2	4	6	8
Min Green 1 *	12	7	12	7
Extension 1 *	6.0	2.0	6.0	2.0
Max Green 1 *	90	25	90	25
Yellow Clearance	4.7	4.1	4.7	4.1
Red Clearance	1.0	1.3	1.0	1.3
Red Revert	-	-	-	-
Walk 1 *	-	-	-	-
Don't Walk 1	-	-	-	-
Seconds Per Actuation *	2.5	-	2.5	-
Max Variable Initial *	34	-	30	-
Time Before Reduction *	15	-	15	-
Time To Reduce *	30	-	30	-
Minimum Gap	3.0	-	3.0	-
Recall Mode	MIN RECALL	-	MIN RECALL	-
Vehicle Call Memory	YELLOW	-	YELLOW	-
Dual Entry	-	ON	-	ON
Simultaneous Gap	ON	-	ON	-

* These values may be field adjusted. Do not adjust Min Green and Extension times for phases 2 and 6 lower than what is shown. Min Green for all other phases should not be lower than 4 seconds.

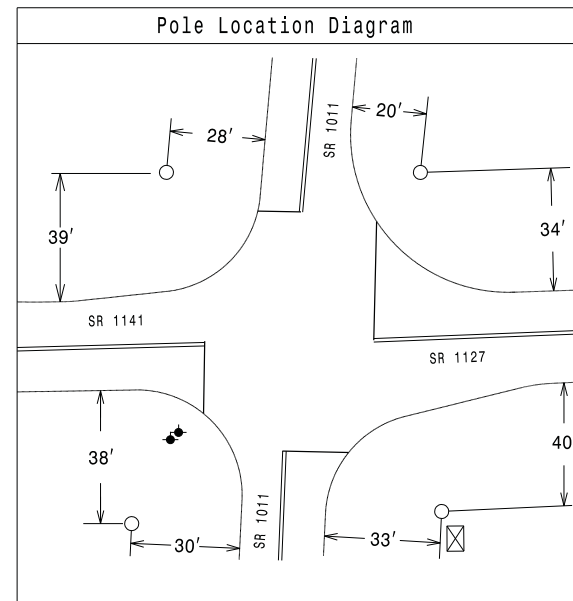

LEGEND	
PROPOSED	EXISTING
○	●
⊠	⊠
□	□
---	---
N/A	---
→	→
○	○
○	○
N/A	---
N/A	---
N/A	○
N/A	---
N/A	⊠

New Installation

2610 WYCLIFF ROAD
SUITE 410
RALEIGH, NC 27607
PHONE: 919.881.9939
NC COA No. F-0929

SR 1127 (New Hill Holleman Rd) & SR 1141 (New Hill Olive Hwy Chapel Rd) at SR 1011 (Old US 1)

Division 5 Wake County New Hill

PLAN DATE: April 2020 REVIEWED BY: JT Brooks

PREPARED BY: P. Padilla REVIEWED BY:

DOCUMENT NOT CONSIDERED FINAL UNLESS ALL SIGNATURES COMPLETED

SEAL

Seal Redacted - Not for Construction

750 N. Greenfield Pkwy, Garner, NC 27529

SCALE 0 30

1" = 30'

8/28/2020 8:56:19 AM
USER: jml